



GENERAL	Number of Floor : 6 Floors	Guest Elevator : 2	Check In : 14:00
	Total Room : 138 Rooms	Room Key : Key Card	Check Out : 12:00
	Tax & Service Charge : 21%		

CONCEPT A Lifestyle Hotel for Families and Couples with eclectic design meets modern interior, Marble tile rooms and trendy hangout restaurants.

GREAT LOCATION Located in the heart of Seminyak area, where the center of decorative restaurant, lifestyle shopping area, upscale shops and hang outs

RESORT FEATURES & FACILITIES	138 New Furnished Room & Suites	Kids Club with children wall climbing
	Nakula & Sadewa for up to 100 delegates standing/coktail	Library
	Tropical Swimming Pool : Kids Pool with slide, Roof Top Pool,	Baby Sitter Service
	Pool Bar	Roof Deck Restaurant
	Fitness Center & Spa	Connecting Rooms
	Car Rental	24 Hours Security & CCTV
	J-Gallery	Business Center
	Wifi All Area	

RESTAURANT & BAR The Clubhouse at Rooftop
Frestro & Bar, a gourmet artisan restaurant adjacent to the hotel

ROOM FACILITIES	FREE WiFi	
	40" Flat Screen Television with Cable TV	Mini Bar
	Tea & Coffee Maker	Telephone
	Safe Deposit Box	Hair Dryer

ROOM TYPE	CATEGORIES	ROOM SIZE	NUMBERS OF ROOMS
	SUPERIOR	30 SQM	61
	DELUXE	35 SQM	40
	DELUXE PREMIER	40 SQM	28
	JUNIOR SUITE	45 SQM	4
	FAMILY SUITE	60 SQM	3
	JAMBULUWUK SUITE	78 SQM	2

TRANSPORTATION	DESTINATION	DISTANCE	BY
	NGURAH RAI	10 km 20 min	Car
	UBUD	30 km 60 min	Car
	NUSA DUA	18 km 35 min	Car
	DENPASAR	10 km 20 min	Car
	TANAH LOT	16 km 30 min	Car
	SANUR	16 km 30 min	Car
	ULUWATU	26 km 50 min	Car

VISITOR INFORMATION	Currency : Indonesian Rupiah (IDR)	Climate : Tropical with dry season
	Card Acceptable : Visa, Master & Amex	is from April to October. Rainy season from November to March.

MEETING ROOMS, CONVENTION CENTER, & BANQUET

VENUE	DIMENSION L x W x H (m)		AREA (m ²)	LAYOUT				
				Classroom	Theatre	U-Shape	Coktail	Banquet
Nakula Sadewa Meeting Room	m	16 x 9.8 x 4.5	156	60	120	30	180	64
	ft	52' x 32' x 15'	1688					

1ST FLOOR

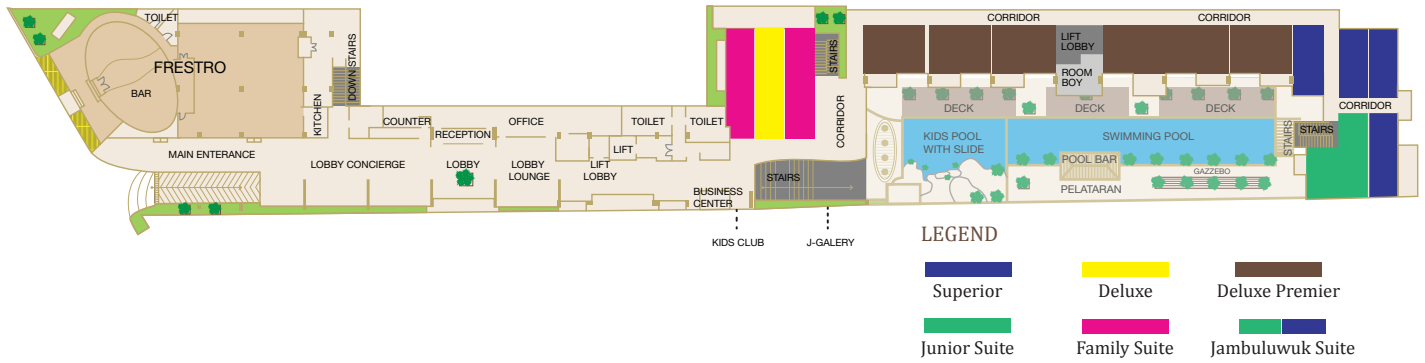

FLOOR PLAN ROOFTOP

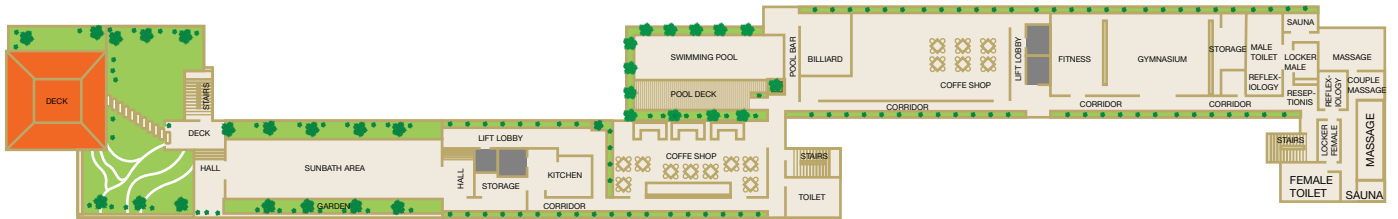

HOTEL'S LOCATION

